New Ideal Holdings p.l.c.

Goldsworth House,
St. John's Road,
Woking,
Surrey GU21 1QX

Telephone Woking (04862) 76155

CENTRAL AREA, GOLDSWORTH PARK UNDERWAY

WAITROSE TO LEASE SUPERMARKET

The Mayor of Woking, Councillor Mrs D E Butler, marked the start of work today (July 9th 1982) at New Ideal Holdings' Central Area Development, Goldsworth Park, Woking, by breaking the ground with a mechanical digger.

The first phase of this scheme will comprise a retail area of 40,400 sq ft to include a supermarket of 26,000 sq ft and a range of standard units, a car park for 240 cars, a public house and petrol filling station. Terms have been agreed with Waitrose to take the lease on the supermarket.

It is anticipated that trading will commence during the autumn of 1983.

Future phases of the Central Area will include offices, health centre, a church and community hall.

The scheme is being undertaken by New Ideal Holdings p.l.c. in association with Trafalgar House Developments Limited who will be acting as project manager. The main building contractors will be New Ideal Homes Limited.

When complete, the total Goldsworth development will cover some 680 acres with around 4,000 homes.

HERITAGE WALKS ARCHIVE DOCUMENT 27...

A Trafalgar House Company

Directors: E.W. Parker, FCA, (Chairman), D.M. Calverley, FCA,
(Managing Director), D.M. Taylor, FCA, A. Gladwin.

Registered in London. Company Number 288115
Registered Office: 681 Mitcham Road, Croydon, Surrey CR9 3AP.

St John's Road
Walsley
Sovereign 1424
Telephone Walsley 04952 74124

New Ideal Holdings set up its commercial development department to take advantage of mixed residential/commercial schemes with its subsidiary companies New Ideal Homes, Southern Ideal Homes and Northern Ideal Homes. The Central Area, Goldsworth Park is the first scheme of this type to be undertaken by the company.

Professional Team

- Architects: Scott Brownrigg & Turner
- Structural Engineers: L G Mouchell & Partners
- Quantity Surveyors: Axtell Yates Hallett
- Service Engineers: Troup Bywaters & Anders
- Agent: Healey & Baker

HERITAGE WALKS ARCHIVE DOCUMENT

CENTRAL AREA, GOLDSWORTH PARK, WOKING

START OF WORK CEREMONY

JULY 9TH 1982

HERITAGE WALKS ARCHIVE DOCUMENT

Itinerary

11.30	Coffee
11.45	Arrival of Mayor of Woking, Cllr. Mrs D E Butler
12.00	Transport by coach to the site.
12.15	Official start of work ceremony. Welcoming speech by David Calverley, Managing Director, New Ideal Holdings p.l.c. Response by the Mayor.
12.45	Arrive back at the Exhibition Centre for lunch. David Calverley will introduce Brian McCombie, Director of Trafalgar House Developments for technical details on the scheme.
1.45	Mayor departs.

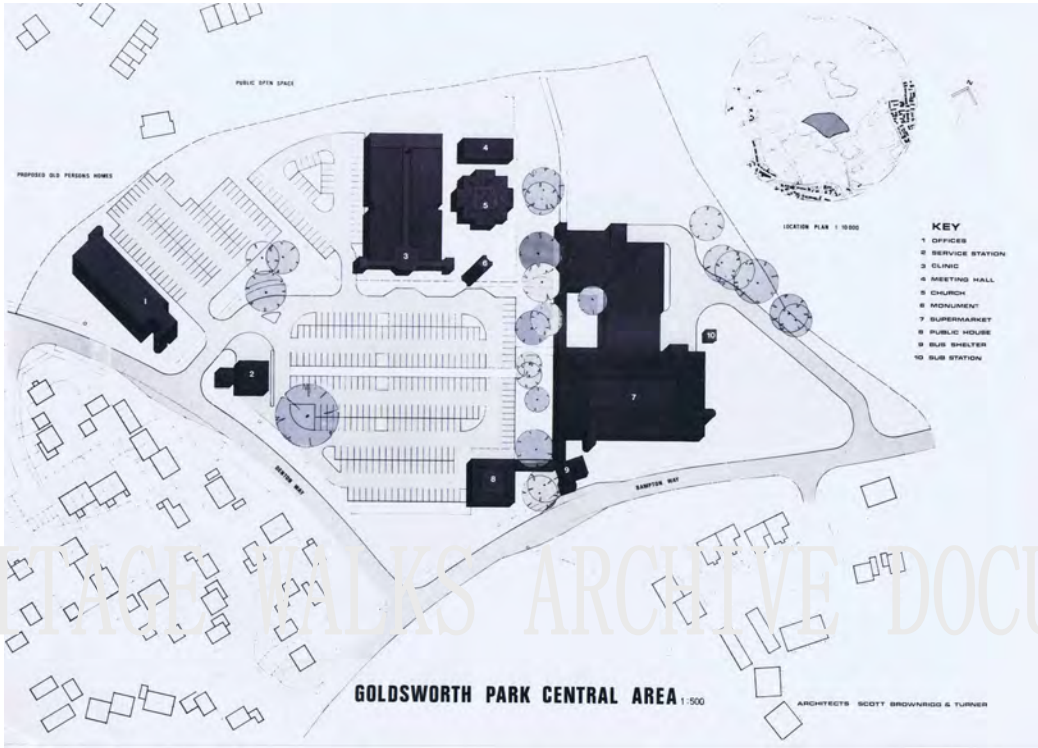

HERITAGE WALKS ARCHIVE DOCUMENT